

**INSULATORS STAND-OFF**

**600 Volts Rated**

**Compression Moulded**

**Glass Reinforced Polyester Material**

- \*High Dielectric Strength
- \*Arc Quenching and Non Tracking
- \*Non Flammable
- \*Wear and Corrosion Resistant
- \*Chemical and Oil Resistant

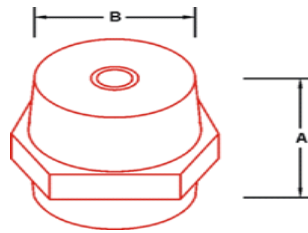

- \*High Mechanical Strength
- \*Dimensional Stability
- \*Moulded-In Brass Inserts
- \*Metric and Imperial Thread Sizes
- \*Quality Finish and Appearance

<b>PART NO.</b>	<b>TYPE</b>	<b>HEIGHT A (mm)</b>	<b>THREAD</b>
BBLV25H	H	25	M6
BBLV30H	H	30	M8
BBLV40H8	H	40	M8
BBLV40H	H	40	M10
BBLV50H	H	50	M10
BBLV60H	H	60	M12
BBLV75D	D	75	M10

**3.3 - 24KV Rated**

**Compression Moulded**

**Glass Reinforced Polyester Material**



<b>PART NO.</b>	<b>RATED VOLTAGE</b>	<b>HEIGHT (mm)</b>	<b>DIAMETER (mm)</b>
EL3M	3.3kv	60	70
EL6M	6.6kv	90	70
EL12	12kv	130	58
EL15	15kv	142	70
EL24	24kv	210	70